

Technology Workstand Line
Mobile Presentation Workstand

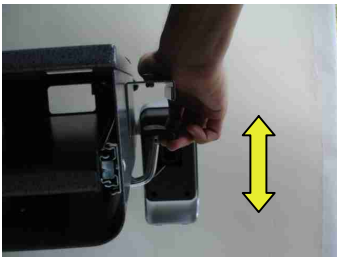

CUSTOMER SERVICE OR TECHNICAL SUPPORT CALL: 800-880-3988 ext. 301

17233 Newhope Street, Suite G
Fountain Valley, CA 92708
714-668-8800 • www.Technologyworkstand.com



Height Adjustable Shelf

The Workstand adjusts from 28"-39", it can be used sitting or standing. To adjust the height, grasp the handles with both hands and gently pull up on the height adjustment bar while pulling up on the handles. To lower the height, take the same action as above but exert some force on the shelf in a downward motion.

Laptop Drawer

A pull out drawer holds the laptop. To lock the drawer, slide the bar up (make sure the bar inserts into slots on shelf lid) and use combination padlock to lock the bar into place. See last page for directions to reset lock combination.

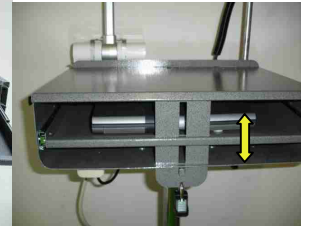

Cylinder

The chrome portion of the cylinder is lubricated, do not touch this part of the cylinder!

Speakers

Some Workstands come with speakers that have been securely mounted to the side of the shelf. To remove the speakers unfasten the screws from the inside of the shelf.



Power Strip

A six socket power strip & surge protector is located on the underneath of the shelf. All equipment may be plugged into this strip. A 20' cord provides ample length to plug into wall outlets in the classroom.

Cords

All equipment cords are housed inside the shelf. To access the cords unlock the padlock on the rear and slide the shelf lid forward.

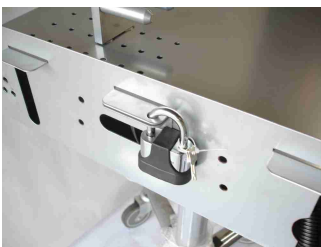

Shelf Lock

A re-settable combination padlock locks the shelf on the rear as well as the front drawer. See last page for lock instructions.

Counter Weight

A custom counter weight is attached underneath the foot rest plate.



Whiteboard

A removable whiteboard with magnetic backing is provided to use with the Elmo. Dry erase markers should be used on this board.

Shelf Extension

A removable 10"x10" plate provides extra work space on the shelf. Slide the plate onto knobs on handles and tighten with screws from the inside of shelf for safety.

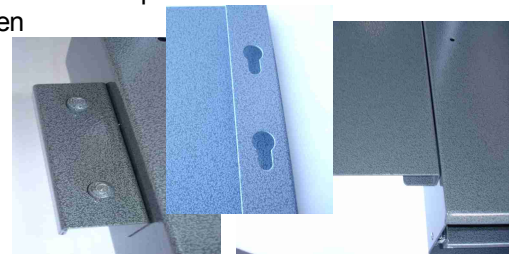



Elmo Document Camera Removal

To remove the Elmo document camera from the cart first remove the padlock shown in a. Beneath the plate holding the document camera there is a long metal slide bar. You must slide this to the right as shown in b. Once this is done you slide the document camera bracket to the right and pull up, shown in c. Now your document camera can be safely removed.

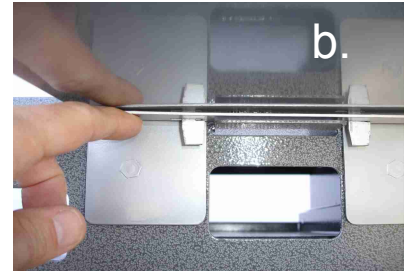

Combination Lock Directions

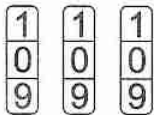

The combination is set to open at 0-0-0 or 0-0-0-0 by default. To set your own combination:

To Open: Turn each wheel to 0 and depress the shackle
 To Lock: Scramble any wheel and depress the shackle

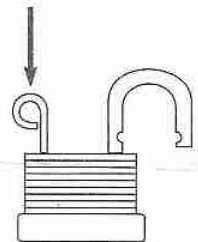

To Change the Combination:

1. Open lock with the present combination. (0-0-0 or 0-0-0-0)
2. Insert the change pin into the shackle hole and press as far as it will go. (If pin is not fully depressed, then a lost combination might occur)
3. Leave the pin in the shackle hole.
4. Turn the wheels and set your own private number. **WRITE THIS NUMBER DOWN**
5. Pull out the pin and the lock is set to the new number.
6. To Lock: Scramble the wheels and depress the shackle.

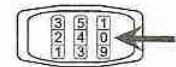

17233 Newhope Street, Suite G
 Fountain Valley, CA 92708

714-668-8800 • www.Technologyworkstand.com

CUSTOMER SERVICE OR TECHNICAL SUPPORT CALL: 800-880-3988 ext. 301